

TURN KEY

Fully Assembled

12X16 APPLE BLOSSOM COTTAGE

LIVING SOLUTIONS

LIVING SOLUTIONS



A complete turn-key design built and delivered fully assembled to your site, the Apple Blossom Cottage makes an amazing rustic retreat in the woods or guest house in the back forty. With its full insulation package, wood stove, plumbing and electrical, this charming sanctuary is ready to be enjoyed all year round.



This turn-key cottage comes fully insulated with basic plumbing, electrical and heating options for year round living. Note: Pictures may reflect client upgrades and modifications that do not come standard.

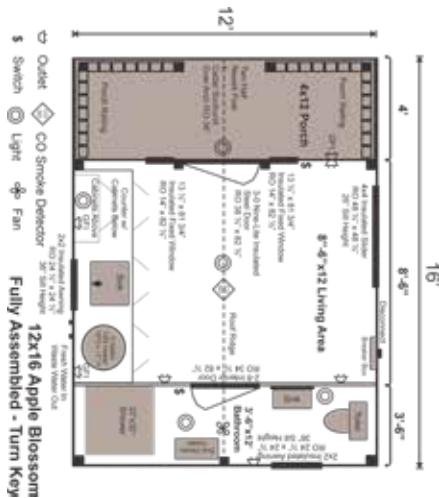

12X16 APPLE BLOSSOM COTTAGE TURN-KEY

- Base Area: 192 sq. ft.
- Total Interior Area: 144 sq. ft.
- Porch Area: 48 sq. ft.
- Recommended Foundation: Compacted 12" Crushed Gravel
- Overall Dimensions: 10'6"H x 13'2"W x 17'2"D
- Estimated Weight: 12340 lbs

Floor System

- 2 (qty) 6x6x16' Hemlock Skids
- 2"x6" Kiln Dried Spruce Joists 24" On Center
- ¾" CDX Plywood Floor Decking
- 1" rough sawn Hemlock Porch Decking
- Floor Vapor Barrier
- 5½" Fiberglass Insulation (R21)
- Under Deck Sheathing: 3/8" Plywood
- Floor Weight Rating: 25 lbs/sq. ft.

Walls

- 4"x4" Hemlock Post and Beam Wall Framing
- Wall Height: 82"
- 12 In/ft of Full Interior Partitions
- Wall Vapor Barrier
- Foil Backed Rigid Foam Insulation (R13)
- Shiplap Pine Interior Sheathing
- Siding: 1" rough sawn Pine Board & Batten
- 1" rough sawn Pine Corner, Door & Window Trim & 2" rough sawn Pine Fascia & Shadow Trim

Roof

- Gable Roof Style
- Roof Pitch: 4/12
- Roof Features: Decorative Cedar Sunburst Arch

FULLY ASSEMBLED:

A weather tight shell. Specifications are the same as a PCK. Fully assembled prefabricated sheds and cottage buildings deliver exclusively to the northeast USA.

EVERY KIT INCLUDES

- Color Coded
- Part Numbered
- Step-by-Step Instructions
- & All Fastening Hardware Included

Configure Yours at

WWW.JAMAICACOTTAGESHOP.COM

ABC.12X16.TK

©2021 Jamaica Cottage Shop, Inc. • 1-802-210-1249 • www.JamaicaCottageShop.com

TURN KEY
Fully Assembled



12X16 APPLE BLOSSOM COTTAGE

LIVING
SOLUTIONS

LIVING
SOLUTIONS



2"x6" Kiln Dried Spruce
Rafters 24" On Center
1"x6" Kiln Dried Spruce
Exposed Collar Ties
1" rough sawn Solid Barn
Board Roof Sheathing
Roof Vapor Barrier
5½" Fiberglass Insulation (R21)
Shiplap Pine Interior Ceiling Sheathing
Corrugated 29g Metal
Roofing, Color: Evergreen

Door & Windows:

Door: 1 (qty) 3-0 nine-lite Insulated
Steel Door with Keyless Lever Locking
Hardware, 1 (qty) 2-8 Pine Interior
Four-Panel Door w/Privacy Hardware
Windows: 2 (qty) 2'x2' Insulated
Awning Window: White Vinyl Interior/
Exterior w/ Screen, 1 (qty) 4'x4'
Insulated Slider Window: White Vinyl
Interior/Exterior w/ Screen, 2 (qty)
13 1/2" x 81 3/4" Insulated Fixed
Window: White Vinyl Interior/Exterior

Additional Features

8 In/ft Treated Railing on Porch
w/ 2 (qty) 1/2 Newell Posts
Plumbing Package: Fresh Water
In, Waste Water Out; 1 (qty) Sink
for Living Area; 1 (qty) Sink for
Bathroom; 1 (qty) 32x32 Shower Stall
in bathroom; 1 (qty) toilet; 1 (qty)
5 gal. Electric Hot Water Heater
Electrical Package; 100 amp Service;
4 (qty) Interior Lights; 1 (qty) Exterior
Light; 2 (qty) Wall Switches; 1 (qty)
Hard-wired CO/Smoke Detector; 1
(qty) Exterior GFI Outlet; 2 (qty) Interior
GFI Outlets; 4 (qty) Interior outlets;
1 (qty) Fan in Bathroom; Envi Electric
Heater; 1 (qty) Exterior Disconnect
Built in Kitchen Counter w/ Cabinets
Below and Cabinets Above

Delivery & Logistics Information

Fully Assembled prefabricated sheds
and cottage buildings are deliverable
exclusively to the Northeast USA.

EVERY KIT INCLUDES

- Color Coded
- Part Numbered
- Step-by-Step Instructions
- & All Fastening Hardware Included

Configure Yours at

WWW.JAMAICACOTTAGESHOP.COM

©2021 Jamaica Cottage Shop, Inc. • 1-802-210-1249 • www.JamaicaCottageShop.com