

# FULLY ASSEMBLED



Nobody likes to wait for the bus in the rain. This mini shelter makes an excellent escape from the elements at the end of your driveway for your kids while they wait for their bus.

## 4X6 BUS STOP

STORAGE SOLUTIONS

STORAGE SOLUTIONS

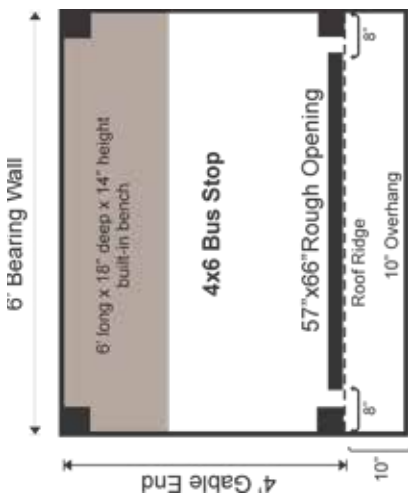

### 4X6 BUS STOP FULLY ASSEMBLED

Base Area: 24 sq. ft.

Total Interior Area: 24 sq. ft.

Recommended Foundation:

3-4" Crushed Gravel

Overall Dimensions: 8'6"H  
x 6'10W x 6'5"D

Estimated Weight: 1000 lbs

#### Floor System

2 (qty) 4x6x6' Hemlock Skids

2"x6" rough sawn Hemlock

Joists 24" On Center

1" rough sawn Hemlock Decking

Floor Weight Rating: 25 lbs/sq. ft.

#### Walls

4"x4" Hemlock Post and  
Beam Wall Framing

Wall Height: Front: 80" Rear: 50"

Siding: 1" rough sawn Pine Board

1" rough sawn Pine Corner &

Door Trim & 1" rough sawn

Pine Fascia & Shadow Trim

The fully assembled unit includes hemlock framing, pine board and batten siding, floor decking, corrugated metal roof, and a built-in bench. Note: Pictures may reflect client upgrades and modifications that do not come standard.

#### Roof

Saltbox Roof Style

Roof Pitch: Front: 8/12 Rear: 8/12 8/12

2"x6" rough sawn Hemlock

Rafters 24" On Center

1"x6" rough sawn Hemlock

Exposed Collar Ties

1"x4" rough sawn Hemlock

Strapping 20" On Center

Corrugated 29g Metal

Roofing, Color: Evergreen

10" Front Overhang

#### Rough Opening:

1 (qty) 57"W x 66"H

#### Additional Features

6' Long x 18" Deep x 14" High

rough sawn Pine Bench

#### Delivery & Logistics Information

Fully Assembled prefabricated sheds and cottage buildings are deliverable exclusively to the Northeast USA.

### FULLY ASSEMBLED:

A weather tight shell. Specifications are the same as a PCK. Fully assembled prefabricated sheds and cottage buildings deliver exclusively to the northeast USA.

EVERY KIT INCLUDES

- Color Coded
- Part Numbered
- Step-by-Step Instructions
- & All Fastening Hardware Included

Configure Yours at

WWW.JAMAICACOTTAGESHOP.COM

BSTP.4X6.FA

©2020 Jamaica Cottage Shop, Inc. • 1-802-210-1249 • www.JamaicaCottageShop.com