

# COMPLETE Pre-Cut Kit

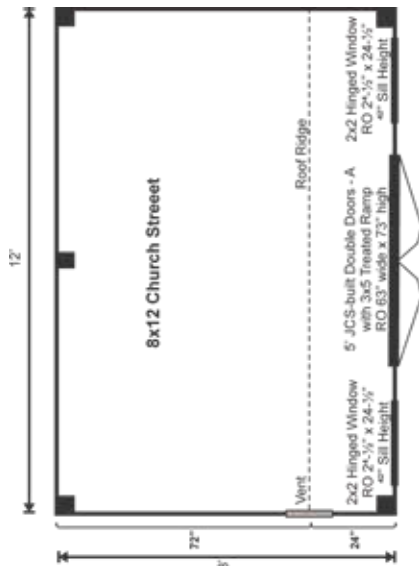

We took our Saltbox shed and gave it some flair. The roofing is upgraded to architectural asphalt shingles with a copper roll ridge cap and the siding is horizontal Eastern White pine clapboard.



## COMPLETE PRE-CUT KIT:

A weather tight shell. The PCK is the complete kit for a design. It includes everything required to assemble the building shell and includes doors and windows.

## EVERY KIT INCLUDES

- Color Coded
- Part Numbered
- Step-by-Step Instructions
- & All Fastening Hardware Included

Configure Yours at

[WWW.JAMAICACOTTAGESHOP.COM](http://WWW.JAMAICACOTTAGESHOP.COM)

# 8X12 CHURCH STREET

STORAGE  
SOLUTIONS



## 8X12 CHURCH STREET COMPLETE PRE-CUT KIT

Base Area: 96 sq. ft.

Total Interior Area: 96 sq. ft.

Recommended Foundation:  
4–6" Crushed Gravel

Overall Dimensions: 10'6"H  
x 13'2"W x 8'10"D

Estimated Weight: 3500 lbs

### Floor System

- 2 (qty) 4"x6"x12' Hemlock Skids
- 2"x6" rough sawn Hemlock Joists 24" On Center
- 3/4" CDX Plywood Floor Decking
- Floor Weight Rating: 25 lbs/sq. ft.

### Walls

- 4"x4" Hemlock Post and Beam Wall Framing
- Wall Height: Front: 83" Rear: 71"
- Siding: Horizontal Pine Clapboard
- 1" rough sawn Pine Corner, Door & Window Trim & 2" rough sawn Pine Fascia & Shadow Trim

### Roof

Saltbox Roof Style

The complete pre-cut kit includes hemlock framing, pine clapboard siding, floor decking, asphalt shingle roof, double doors and barn sash windows. Note: Pictures may reflect client upgrades and modifications that do not come standard.

Roof Pitch: Front: 12/12 Rear: 6/12  
2"x6" rough sawn Hemlock Rafters 24" On Center

1"x6" rough sawn Hemlock Exposed Collar Ties

1" rough sawn Solid Barn Board Roof Sheathing

Black Architectural Asphalt Shingles with Copper Roll Ridge Cap

### Doors & Windows:

Door: 1 (qty) 5-0 JCS-built 2" Thick rough sawn Pine Double Doors w/ 3x5 Pressure Treated Ramp

Windows: 2 (qty) 2'x2' six-lite Hinged Barn Sash Window

### Additional Features

1 (qty) Wood Louvered Vent

Assembly & Logistics Information

Estimated Assembly Time:

Two People: 24 hrs

Estimated Shipping Cube Sizes

Cube 1: 42"x46"x144"

CHURCH.8X12.PCK