

FULLY ASSEMBLED

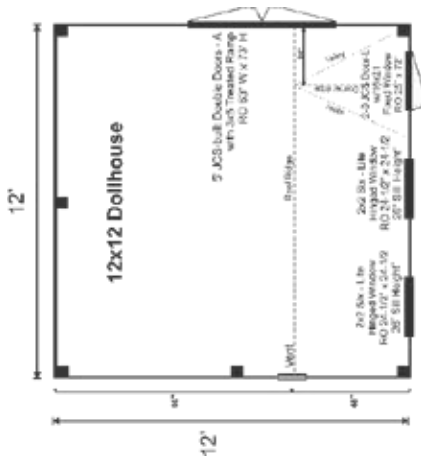

The darling Dollhouse entices our customers who are looking for a garden shed or playhouse with a dash of sophistication. The steep dormer above the single door and barn sash windows create an inviting space for all.



FULLY ASSEMBLED:

A weather tight shell. Specifications are the same as a PCK. Fully assembled prefabricated sheds and cottage buildings deliver exclusively to the northeast USA.

EVERY KIT INCLUDES

- Color Coded
- Part Numbered

• Step-by-Step Instructions
• All Fastening Hardware Included

Configure Yours at

WWW.JAMAICACOTTAGESHOP.COM

12X12 DOLLHOUSE

STORAGE SOLUTIONS



12X12 DOLLHOUSE FULLY ASSEMBLED

Base Area: 144 sq. ft.

Total Interior Area: 144 sq. ft.

Recommended Foundation:
6–8" Crushed Gravel

Overall Dimensions: 10'6"H
x 13'2"W x 13'2"D

Estimated Weight: 4400 lbs

Floor System

2 (qty) 4x6x12' Hemlock Skids

2"x6" rough sawn Hemlock

Joists 24" On Center

¾" CDX Plywood Floor Decking

Floor Weight Rating: 25 lbs/sq. ft.

Walls

4"x4" Hemlock Post and Beam Wall Framing

Wall Height: 60" Dormer Wall Height: 60"

Siding: 1" rough sawn Pine Board & Batten

1" rough sawn Pine Corner, Door
& Window Trim & 2" rough sawn
Pine Fascia & Shadow Trim

Roof

Gable Roof Style

Roof Pitch: Front: 12/12 Rear:
6/12 Dormer: 24/12

2"x6" rough sawn Hemlock
Rafters 24" On Center

The fully assembled unit includes hemlock framing, pine board and batten siding, floor decking, corrugated metal roof, windows and doors. Note: Pictures may reflect client upgrades and modifications that do not come standard.

1"x6" rough sawn Hemlock
Exposed Collar Ties

1"x4" rough sawn Hemlock
Strapping 20" On Center

Corrugated 29g Metal Roofing,
Color: Evergreen

Aluminum Valley Flashing

Doors & Windows:

Doors: 1 (qty) 2-0 JCS-built 2" Thick rough
sawn Pine Single Door with 16"x21"
Fixed Window, no ramp, 1 (qty) 5-0 JCS-
built 2" Thick rough sawn Pine Double
Doors w/ 3x5 Pressure Treated Ramp

Windows: 2 (qty) 2'x2' six-lite
Hinged Barn Sash Window

Additional Features

1 (qty) Wood Louvered Vent

Delivery & Logistics Information

Fully Assembled prefabricated sheds
and cottage buildings are deliverable
exclusively to the Northeast USA.

DOLL.12X12.FA

STORAGE SOLUTIONS

