

4-SEASON Pre-Cut Kit

10X16 GABLE

LIVING
SOLUTIONS

LIVING
SOLUTIONS



We describe the Gable as a strong and sturdy storage shed with a traditional barn style. The design is simple and blends into it's surroundings or can be dressed up with customizations to create a one of a kind structure.

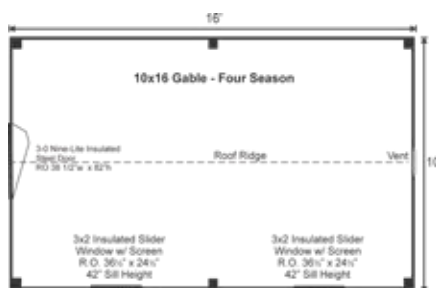

4-SEASON KITS:

The package includes the complete kit plus vapor barrier, insulation, solid pine roof sheathing, ship lap pine interior wall and ceiling sheathing, double-pane, energy efficient windows and an insulated steel door.

EVERY KIT INCLUDES

- Color Coded
- Part Numbered
- Step-by-Step Instructions
- & All Fastening Hardware Included

Additional Sizes:

8X8 | 8X10 | 8X12 | 8X14 | 8X16 |
10X8 | 10X10 | 10X12 | 10X14 | 10X16 | 10X18 |
10X20 | 12X12 | 12X14 | 12X16 | 12X20 | 12X24

Additional Types:

FRAME ONLY KIT | COMPLETE KIT | FULLY
ASSEMBLED | 3-SEASON KIT | 4-SEASON KIT

Configure Yours at

WWW.JAMAICACOTTAGESHOP.COM

10X16 GABLE 4-SEASON PRE-CUT KIT

Base Area: 160 sq. ft.

Total Interior Area: 160 sq. ft.

Recommended Foundation:

8-10" Crushed Gravel

Overall Dimensions: 10'6"H x 11'8"W x 17'8"D

Estimated Weight: 7900 lbs

Floor System

- 2 (qty) 6x6x16' Hemlock Skids
- 2"x6" Kiln Dried Spruce Joists 24" On Center
- ¾" CDX Plywood Floor Decking
- Floor Vapor Barrier
- 5½" Fiberglass Insulation (R21)
- Under Deck Sheathing: 3/8" Plywood
- Floor Weight Rating: 25 lbs/sq. ft.

Walls

- 4"x4" Hemlock Post and Beam Wall Framing
- Wall Height: 78"
- Wall Vapor Barrier
- Foil Backed Rigid Foam Insulation (R13)
- Shiplap Pine Interior Sheathing
- Siding: 1" rough sawn Pine Board & Batten
- 1" rough sawn Pine Corner, Door & Window Trim & 2" rough sawn Pine Fascia & Shadow Trim

The 4-season kit includes the complete kit plus insulation throughout, roof sheathing, interior shiplap pine wall and ceiling sheathing, double pane windows and an insulated door. Note: Pictures may reflect client upgrades and modifications that do not come standard.

Roof

- Gable Roof Style
- Roof Pitch: 6/12
- 2"x6" Kiln Dried Spruce Rafters 24" On Center
- 1"x6" Kiln Dried Spruce Exposed Collar Ties
- 1" rough sawn Solid Barn Board Roof Sheathing
- Roof Vapor Barrier
- 5½" Fiberglass Insulation (R21)
- Shiplap Pine Interior Ceiling Sheathing
- Corrugated 29g Metal Roofing, Color: Evergreen

Door & Windows:

- Door: 1 (qty) 3-0 nine-lite Insulated Steel Door with Keyless Lever Locking Hardware
- Windows: 2 (qty) 3'x2' Insulated Awning Window
- Window: White Vinyl Interior/Exterior w/ Screen

Assembly & Logistics Information

- Estimated Assembly Time: Two People: 62 hrs
- Estimated Shipping Cube Sizes
- Cube 1: 42"x44"192" Cube 2:
42"x48"x192" Cube 3: 42"x48"x192"

GBLL.10X16.4SPCK