

COMPLETE Pre-Cut Kit

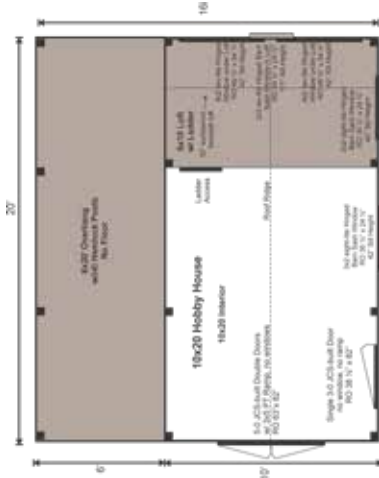

The Hobby House is loaded with features that create a fantastic workshop, art studio, or store. The double barn doors with ramp make it easy to load items in and out, while the storage loft, built-in workbench and overhang prove to be very useful elements for storage.



COMPLETE PRE-CUT KIT:

A weather tight shell. The PCK is the complete kit for a design. It includes everything required to assemble the building shell and includes doors and windows.

EVERY KIT INCLUDES

- Color Coded
- Part Numbered
- Step-by-Step Instructions
- & All Fastening Hardware Included

Additional Sizes:

10X16 | 10X20 | 12X16 | 12X20 | 12X24

Additional Types:

FRAME ONLY KIT | COMPLETE KIT | 3-SEASON KIT | 4-SEASON KIT

Configure Yours at

WWW.JAMAICACOTTAGESHOP.COM

10X20 HOBBY HOUSE

STORAGE
SOLUTIONS



10X20 HOBBY HOUSE COMPLETE PRE-CUT KIT

Base Area: 200 sq. ft.

Loft Area: 60 sq. ft.

Total Interior Area: 260 sq. ft.

Overhang Area: 120 sq. ft.

Recommended Foundation:
8-10" Crushed Gravel

Overall Dimensions: 14'9"H x 17'2"W x 21'2"D

Estimated Weight: 8000 lbs

Floor System

- 2 (qty) 6x6x20' Hemlock Skids
- 6x6 Treated Sill Plate (Overhang)
- 2"x6" rough sawn Hemlock Joists 24" On Center
- 3/4" CDX Plywood Floor Decking
- Floor Weight Rating: 25 lbs/sq. ft.

Loft

- 6x10
- Ladder Access
- 2"x4" rough sawn Hemlock Joists 24" on center
- Smooth Shiplap Pine Loft Decking
- Weight Rating 10 lbs / sqft

Walls

- 4"x4" Hemlock Post and Beam Wall Framing
- Wall Height: 96"
- Siding: 1" rough sawn Pine Board & Batten
- 1" rough sawn Pine Corner, Door & Window Trim
- & 2" rough sawn Pine Fascia & Shadow Trim

The complete pre-cut kit includes hemlock framing, pine board and batten siding, floor decking, corrugated metal roof, pine door and barn sash windows. Note: Pictures may reflect client upgrades and modifications that do not come standard.

Roof

Gable Roof Style

Roof Pitch: 12/12 Overhang: 3/12

2"x6" rough sawn Hemlock Rafters 24" On Center

1"x6" rough sawn Hemlock Exposed Collar Ties

1"x4" rough sawn Hemlock Strapping 20" On Center

Corrugated 29g Metal Roofing, Color: Evergreen

6x20 Overhang

2x6 rough sawn Hemlock Rafters 24" On Center

Doors & Windows:

Doors: 1 (qty) 3-0 JCS-built 2" Thick rough sawn Pine Single Door, no ramp, 1 (qty) 5-0 JCS-built 2" Thick rough sawn Pine Double Doors w/ 3x5 Pressure Treated Ramp

Windows: 2 (qty) 3'x2' eight-lite Hinged Barn Sash Window, 1 (qty) 2'x2' six-lite Hinged Barn Sash Window, 2 (qty) 4'x2' ten-lite Hinged Barn Sash Windows

Additional Features

10'L rough sawn Pine Work Bench 34" Finish Height, 30" Finish Depth

Assembly & Logistics Information

Estimated Assembly Time: Two People: 34 hrs

Estimated Shipping Cube Sizes

Cube 1: 42"x54"x192" Cube 2:
42"x40"x120" Cube 3: 42"x40"x144"

HBBY.10X20.PCK