

FULLY ASSEMBLED

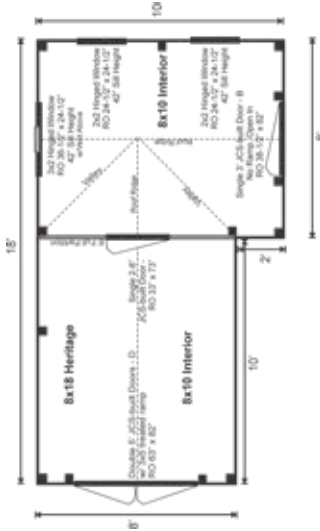

The two room Heritage includes a double door providing adequate entry for a lawn tractor, and recreational vehicles. With the addition of a workbench, or cabinet space, the interior is versatile. The Heritage can be converted into a workshop or modified for tiny living.



FULLY ASSEMBLED:

A weather tight shell. Specifications are the same as a PCK. Fully assembled prefabricated sheds and cottage buildings deliver exclusively to the northeast USA.

EVERY KIT INCLUDES

- Color Coded
- Part Numbered
- Step-by-Step Instructions
- All Fastening Hardware Included

Additional Sizes:

8X18 | 10X20 | 10X24 | 12X20 | 12X24 |

Additional Types:

FRAME ONLY KIT | COMPLETE KIT | FULLY ASSEMBLED | 3-SEASON KIT | 4-SEASON KIT

Configure Yours at

WWW.JAMAICACOTTAGESHOP.COM

8X18 HERITAGE

STORAGE SOLUTIONS



8X18 HERITAGE FULLY ASSEMBLED

Base Area: 160 sq. ft.

Total Interior Area: 160 sq. ft.

Recommended Foundation:
6-8" Crushed Gravel

Overall Dimensions: 10'6"H
x 19'2"W x 11'2"D

Estimated Weight: 6000 lbs

Floor System

2 (qty) 6x6x18' Hemlock Skids

2"x6" rough sawn Hemlock
Joists 24" On Center

3/4" CDX Plywood Floor Decking

Floor Weight Rating: 25 lbs/sq. ft.

Walls

4"x4" Hemlock Post and Beam Wall Framing

Wall Height: 82"

8' Interior partition

Siding: 1" rough sawn Pine Board & Batten

1" rough sawn Pine Corner, Door
& Window Trim & 2" rough sawn
Pine Fascia & Shadow Trim

Roof

Gable Roof Style

Roof Pitch: 6/12

The fully assembled unit includes hemlock framing, pine board and batten siding, floor decking, corrugated metal roof, pine doors and barn sash windows. Note: Pictures may reflect client upgrades and modifications that do not come standard.

2"x6" rough sawn Hemlock
Rafters 24" On Center

1"x6" rough sawn Hemlock
Exposed Collar Ties

1"x4" rough sawn Hemlock
Strapping 20" On Center

Corrugated 29g Metal Roofing,
Color: Evergreen

Doors & Windows:

Doors: 1 (qty) 3-0 JCS-built 2" Thick rough
sawn Pine Single Door, no ramp, 1 (qty) 5-0
JCS-built 2" Thick rough sawn Pine Double
Doors w/ 3x5 Treated Ramp, 1 (qty) 2-8
JCS-built 2" Thick rough sawn Pine Single
Door, no ramp - installed in partition

Windows: 2 (qty) 2'x2' six-lite Hinged
Barn Sash Window, 1 (qty) 3'x2' eight-
lite Hinged Barn Sash Window

Additional Features

1 (qty) Wood Louvered Vent

Delivery & Logistics Information

Fully Assembled prefabricated sheds
and cottage buildings are deliverable
exclusively to the Northeast USA.

HRTG.8X18.FA