

COMPLETE Pre-Cut Kit

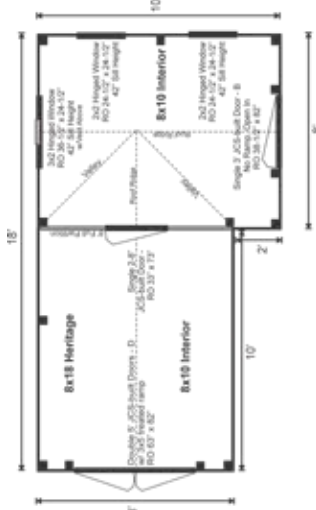

The two room Heritage includes a double door providing adequate entry for a lawn tractor, and recreational vehicles. With the addition of a workbench, or cabinet space, the interior is versatile. The Heritage can be converted into a workshop or modified for tiny living.



COMPLETE PRE-CUT KIT:

A weather tight shell. The PCK is the complete kit for a design. It includes everything required to assemble the building shell and includes doors and windows.

EVERY KIT INCLUDES

- Color Coded
- Part Numbered
- Step-by-Step Instructions
- All Fastening Hardware Included

Additional Sizes:

8X18 | 10X20 | 10X24 | 12X20 | 12X24 |

Additional Types:

FRAME ONLY KIT | COMPLETE KIT | FULLY ASSEMBLED | 3-SEASON KIT | 4-SEASON KIT

Configure Yours at

WWW.JAMAICACOTTAGESHOP.COM

8X18 HERITAGE

STORAGE
SOLUTIONS



8X18 HERITAGE COMPLETE PRE-CUT KIT

Base Area: 160 sq. ft.

Total Interior Area: 160 sq. ft.

Recommended Foundation:
6–8" Crushed Gravel

Overall Dimensions: 10'6"H
x 19'2"W x 11'2"D

Estimated Weight: 6000 lbs

Floor System

2 (qty) 6x6x18' Hemlock Skids

2"x6" rough sawn Hemlock
Joists 24" On Center

¾" CDX Plywood Floor Decking

Floor Weight Rating: 25 lbs/sq. ft.

Walls

4"x4" Hemlock Post and Beam Wall Framing
Wall Height: 82"

8' Interior partition

Siding: 1" rough sawn Pine Board & Batten

1" rough sawn Pine Corner, Door
& Window Trim & 2" rough sawn
Pine Fascia & Shadow Trim

Roof

Gable Roof Style

Roof Pitch: 6/12

2"x6" rough sawn Hemlock
Rafters 24" On Center

The complete pre-cut kit includes hemlock framing, pine board and batten siding, floor decking, corrugated metal roof, pine door and barn sash windows. Note: Pictures may reflect client upgrades and modifications that do not come standard.

1"x6" rough sawn Hemlock
Exposed Collar Ties

1"x4" rough sawn Hemlock
Strapping 20" On Center

Corrugated 29g Metal Roofing,
Color: Evergreen

Doors & Windows:

Doors: 1 (qty) 3-0 JCS-built 2" Thick rough sawn Pine Single Door, no ramp, 1 (qty) 5-0 JCS-built 2" Thick rough sawn Pine Double Doors w/ 3x5 Treated Ramp, 1 (qty) 2-8 JCS-built 2" Thick rough sawn Pine Single Door, no ramp - installed in partition

Windows: 2 (qty) 2'x2' six-lite Hinged Barn Sash Window, 1 (qty) 3'x2' eight-lite Hinged Barn Sash Window

Additional Features

1 (qty) Wood Louvered Vent

Assembly & Logistics Information

Estimated Assembly Time:
Two People: 30 hrs

Estimated Shipping Cube Sizes
Cube 1: 42"x50"x192"

HRTG.8X18.PCK