

FULLY ASSEMBLED

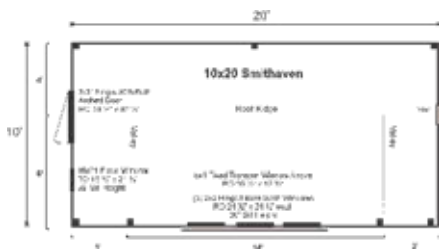

With abundant natural light streaming in from the barn sash and transom windows and the additional headroom provided by the dormer, this unique design is the perfect choice for a workshop, artisan studio, backyard office or a stylish storage shed. Upgrade to four-season for year-round use!



FULLY ASSEMBLED:

A weather tight shell. Specifications are the same as a PCK. Fully assembled prefabricated sheds and cottage buildings deliver exclusively to the northeast USA.

EVERY KIT INCLUDES

- Color Coded
- Part Numbered
- Step-by-Step Instructions
- & All Fastening Hardware Included

Additional Sizes:

10X16 | 10X20 | 10X24 | 12X16 | 12X20 | 12X24

Additional Types:

FRAME ONLY KIT | COMPLETE KIT | FULLY ASSEMBLED | 3-SEASON KIT | 4-SEASON KIT

Configure Yours at

WWW.JAMAICACOTTAGESHOP.COM

10X20 SMITHAVEN

STORAGE SOLUTIONS



10X20 SMITHAVEN FULLY ASSEMBLED

Base Area: 200 sq. ft.

Total Interior Area: 200 sq. ft.

Recommended Foundation:
6-8" Crushed Gravel

Overall Dimensions: 10'6"H x 11'2"W x 21'2"D

Estimated Weight: 5600 lbs

Floor System

2 (qty) 6x6x20' Hemlock Skids

2"x6" rough sawn Hemlock
Joists 24" On Center

3/4" CDX Plywood Floor Decking

Floor Weight Rating: 25 lbs/sq. ft.

Walls

4"x4" Hemlock Post and Beam Wall Framing

Wall Height: Front: 60" Rear: 36"

Dormer Wall Height: 89"

Siding: 1" rough sawn Pine Board & Batten

1" rough sawn Pine Corner, Door
& Window Trim & 2" rough sawn
Pine Fascia & Shadow Trim

Roof

Saltbox Roof Style

Roof Pitch: 12/12 Dormer: 3/12

Roof Features: Dormer with
Aluminum Valley Flashing

The fully assembled unit includes hemlock framing, pine board and batten siding, floor decking, a corrugated metal roof, double doors and barn sash windows. Note: Pictures may reflect client upgrades and modifications that do not come standard.

2"x6" rough sawn Hemlock
Rafters 24" On Center

1"x6" rough sawn Hemlock
Exposed Collar Ties

1"x4" rough sawn Hemlock
Strapping 20" On Center

Corrugated 29g Metal Roofing,
Color: Evergreen

Door & Windows:

Door: 1 (qty) 3-0 JCS-built 2" Thick rough
sawn Pine Arched Single Door, no ramp

Windows: 3 (qty) 2'x2' six-lite Hinged
Barn Sash Window, 1 (qty) 8'x1' Fixed
Transom Window, 1 (qty) 16"x21"
four-lite Fixed Barn Sash Window

Additional Features

1 (qty) Wood Louvered Vent

Delivery & Logistics Information

Fully Assembled prefabricated sheds
and cottage buildings are deliverable
exclusively to the Northeast USA.

SMTH.10X20.FA

STORAGE SOLUTIONS

