

# COMPLETE Pre-Cut Kit

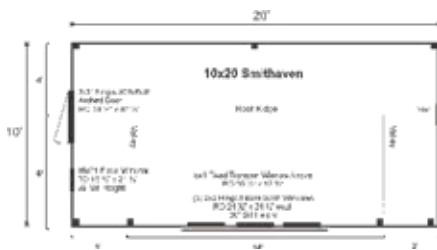

With abundant natural light streaming in from the barn sash and transom windows and the additional headroom provided by the dormer, this unique design is the perfect choice for a workshop, artisan studio, backyard office or a stylish storage shed. Upgrade to four-season for year-round use!



## COMPLETE PRE-CUT KIT:

A weather tight shell. The PCK is the complete kit for a design. It includes everything required to assemble the building shell and includes doors and windows.

## EVERY KIT INCLUDES

- Color Coded
- Part Numbered
- Step-by-Step Instructions
- & All Fastening Hardware Included

### Additional Sizes:

10X16 | 10X20 | 10X24 | 12X16 | 12X20 | 12X24

### Additional Types:

FRAME ONLY KIT | COMPLETE KIT | FULLY ASSEMBLED | 3-SEASON KIT | 4-SEASON KIT

Configure Yours at

[WWW.JAMAICACOTTAGESHOP.COM](http://WWW.JAMAICACOTTAGESHOP.COM)

# 10X20 SMITHAVEN

STORAGE SOLUTIONS



## 10X20 SMITHAVEN COMPLETE PRE-CUT KIT

Base Area: 200 sq. ft.

Total Interior Area: 200 sq. ft.

Recommended Foundation:

6-8" Crushed Gravel

Overall Dimensions: 10'6"H x 11'2"W x 21'2"D

Estimated Weight: 5600 lbs

### Floor System

2 (qty) 6x6x20' Hemlock Skids

2"x6" rough sawn Hemlock

Joists 24" On Center

¾" CDX Plywood Floor Decking

Floor Weight Rating: 25 lbs/sq. ft.

### Walls

4"x4" Hemlock Post and Beam Wall Framing

Wall Height: Front: 60" Rear: 36"

Dormer Wall Height: 89"

Siding: 1" rough sawn Pine Board & Batten

1" rough sawn Pine Corner, Door

& Window Trim & 2" rough sawn

Pine Fascia & Shadow Trim

### Roof

Saltbox Roof Style

Roof Pitch: 12/12 Dormer: 3/12

Roof Features: Dormer with

Aluminum Valley Flashing

The complete pre-cut kit includes hemlock framing, pine board and batten siding, floor decking, corrugated metal roof, pine door and barn sash windows. Note: Pictures may reflect client upgrades and modifications that do not come standard.

2"x6" rough sawn Hemlock

Rafters 24" On Center

1"x6" rough sawn Hemlock

Exposed Collar Ties

1"x4" rough sawn Hemlock

Strapping 20" On Center

Corrugated 29g Metal Roofing,

Color: Evergreen

### Door & Windows:

Door: 1 (qty) 3-0 JCS-built 2" Thick rough sawn Pine Arched Single Door, no ramp

Windows: 3 (qty) 2'x2' six-lite Hinged Barn Sash

Window, 1 (qty) 8'x1' Fixed Transom Window, 1

(qty) 16"x21" four-lite Fixed Barn Sash Window

### Additional Features

1 (qty) Wood Louvered Vent

### Assembly & Logistics Information

Estimated Assembly Time:

Two People: 34 hrs

Estimated Shipping Cube Sizes

Cube 1: 42"x40"x144"

Cube 2: 42"x42"x144"

SMTH.10X20.PCK