

COMPLETE Pre-Cut Kit

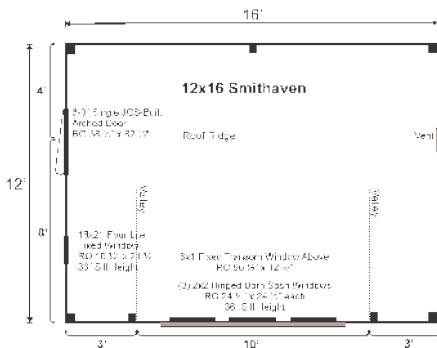

With abundant natural light streaming in from the barn sash and transom windows and the additional headroom provided by the dormer, this unique design is the perfect choice for a workshop, artisan studio, backyard office or a stylish storage shed. Upgrade to four-season for year-round use!



COMPLETE PRE-CUT KIT:

A weather tight shell. The PCK is the complete kit for a design. It includes everything required to assemble the building shell and includes doors and windows.

EVERY KIT INCLUDES

- Color Coded
- Part Numbered
- Step-by-Step Instructions
- & All Fastening Hardware Included

Additional Sizes:

10X16 | 10X20 | 10X24 | 12X16 | 12X20 | 12X24

Additional Types:

FRAME ONLY KIT | COMPLETE KIT | FULLY ASSEMBLED | 3-SEASON KIT | 4-SEASON KIT

Configure Yours at

WWW.JAMAICACOTTAGESHOP.COM

12X16 SMITHAVEN

STORAGE SOLUTIONS



12X16 SMITHAVEN COMPLETE PRE-CUT KIT

Base Area: 192 sq. ft.

Total Interior Area: 192 sq. ft.

Recommended Foundation:

6–8" Crushed Gravel

Overall Dimensions: 10'6"H x 13'2"W x 17'2"D

Estimated Weight: 5600 lbs

Floor System

2 (qty) 6x6x16' Hemlock Skids

2"x6" rough sawn Hemlock

Joists 24" On Center

¾" CDX Plywood Floor Decking

Floor Weight Rating: 25 lbs/sq. ft.

Walls

4"x4" Hemlock Post and Beam Wall Framing

Wall Height: Front: 60" Rear: 36"

Dormer Wall Height: 91"

Siding: 1" rough sawn Pine Board & Batten

1" rough sawn Pine Corner, Door

& Window Trim & 2" rough sawn

Pine Fascia & Shadow Trim

Roof

Saltbox Roof Style

Roof Pitch: Left: 12/12 Right:

9/12 Dormer: 2/12

Roof Features: Dormer with

Aluminum Valley Flashing

The complete pre-cut kit includes hemlock framing, pine board and batten siding, floor decking, corrugated metal roof, pine door and barn sash windows. Note: Pictures may reflect client upgrades and modifications that do not come standard.

2"x6" rough sawn Hemlock

Rafters 24" On Center

1"x6" rough sawn Hemlock

Exposed Collar Ties

1"x4" rough sawn Hemlock

Strapping 20" On Center

Corrugated 29g Metal Roofing,

Color: Evergreen

Door & Windows:

Door: 1 (qty) 3-0 JCS-built 2" Thick rough

sawn Pine Arched Single Door, no ramp

Windows: 3 (qty) 2'x2' six-lite Hinged Barn Sash

Window, 1 (qty) 8'x1' Fixed Transom Window, 1

(qty) 16"x21" four-lite Fixed Barn Sash Window

Additional Features

1 (qty) Wood Louvered Vent

Assembly & Logistics Information

Estimated Assembly Time:

Two People: 34 hrs

Estimated Shipping Cube Sizes

Cube 1: 42"x40"x144"

Cube 2: 42"x42"x144"

SMTH.12X16.PCK