

TURN KEY

Fully Assembled

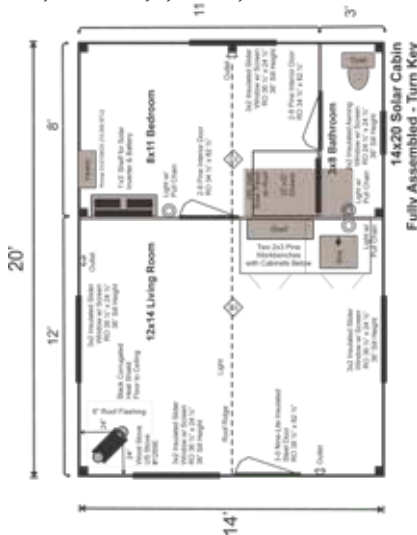

A complete turn-key design built and delivered fully assembled to your site, the Solar Cabin makes an amazing rustic retreat in the woods or guest house in the back forty. With its full insulation package, wood stove, plumbing and solar package, this charming sanctuary is ready to be enjoyed all year round.



TURN-KEY

Turn key structures are four season fully assembled builds that will also include basic electric, heating and plumbing options. These utilities may be traditional or off-grid.

EVERY KIT INCLUDES

- Color Coded
- Part Numbered
- Step-by-Step Instructions
- & All Fastening Hardware Included

Additional Sizes:

14X20 | 14X26 | 14X30 |

Configure Yours at

WWW.JAMAICACOTTAGESHOP.COM

14X20 SOLAR CABIN

LIVING SOLUTIONS



14X20 SOLAR CABIN

TURN-KEY

Base Area: 280 sq. ft.
 Total Interior Area: 280 sq. ft.
 Recommended Foundation:
 Compacted 12" Crushed Gravel
 Overall Dimensions: 10'6"H x 14'9"W x 21'2"D
 Estimated Weight: 15700 lbs

Floor System

2 (qty) 6x6x20' Hemlock Skids
 2"x6" Kiln Dried Spruce Joists 24" On Center
 2x6 Pine Tongue & Groove Decking
 Floor Vapor Barrier
 5½" Fiberglass Insulation (R21)
 Under Deck Sheathing: "Plywood
 Floor Weight Rating: 25 lbs/sq. ft.

Walls

2"x6" Kiln Dried Spruce Wall
 Framing 24" On Center
 Wall Height: 70"
 19 In/ft of Full Interior Partitions
 Wall Vapor Barrier
 3½" Fiberglass Insulation (R13)
 Shiplap Pine Interior Sheathing
 Siding: 1" rough sawn Pine Board & Batten
 1" rough sawn Pine Door, Window, Fascia
 & Shadow Trim Detail, No Soffit

Roof

Gable Roof Style
 Roof Pitch: 5/12
 2"x6" Kiln Dried Spruce Rafters 24" On Center
 1"x6" Kiln Dried Spruce Exposed Collar Ties
 1" rough sawn Solid Barn Board Roof Sheathing
 Roof Vapor Barrier
 5½" Fiberglass Insulation (R21)
 Shiplap Pine Interior Ceiling Sheathing

This turn-key cabin comes fully insulated with off-grid plumbing, electrical and heating options for year round living. Note: Pictures may reflect client upgrades and modifications that do not come standard.

Corrugated 29g Metal Roofing,
 Color: Evergreen

Doors & Windows:

Door: 1 (qty) 3-0 nine-lite Insulated Steel Door with Keyless Lever Locking Hardware, 2 (qty) 2-8 Pine Interior Four-Panel Doors w/ Privacy Hardware
 Windows: 4 (qty) 3'x2' Insulated Slider Window: White Vinyl Interior/Exterior w/ Screen, 1 (qty) 2'x2' Insulated Awning Window: White Vinyl Interior/Exterior w/ Screen

Additional Features

1 (qty) Plumbing Package: Grey Water System for Sink & Shower; 1 (qty) Stainless Steel Sink for Living Area; 1 (qty) 32x32 Shower Stall in bathroom; 1 (qty) Natures Head Composting toilet
 Solar Package; 3 (qty) Pull Chain Interior Lights; 2 (qty) Battery Powered CO/Smoke Detector; 3 (qty) Outlets
 24" Deep x 6 In/ft Workbench w/ Cabinets Below; 6' rough sawn Pine Shelves w/ Brackets; 3' rough sawn Pine Shelves w/ Brackets
 1 (qty) 12" Wood Stove w/ Window; 6" Stovepipe Thimble through Roof; Hearth & Heatshield; Wall Mounted Direct Vent Propane Heater

Delivery & Logistics Information

Fully Assembled prefabricated sheds and cottage buildings are deliverable exclusively to the Northeast USA.

SOL.14X20.TK

