

COMPLETE Pre-Cut Kit

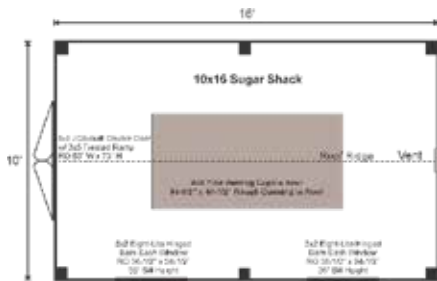

A traditional New England design, the Sugar Shack boasts functionality and aesthetic appeal. Sugar Shacks are traditionally used as a designated building to boil maple syrup. In the springtime a large cloud of smoke and steam can be seen rising high above a sugar shack.



COMPLETE PRE-CUT KIT:

A weather tight shell. The PCK is the complete kit for a design. It includes everything required to assemble the building shell and includes doors and windows.

EVERY KIT INCLUDES

- Color Coded
- Part Numbered
- Step-by-Step Instructions
- & All Fastening Hardware Included

Additional Sizes:

8X10 | 8X12 | 8X14 | 8X16 | 10X16 | 10X20 | 12X16 | 12X20 | 12X24 | 14X20 | 14X24 | 16X20 | 16X24 | 16X30 | 12X30 | 20X40 |

Additional Types:

FRAME ONLY KIT | COMPLETE KIT | FULLY ASSEMBLED | 3-SEASON KIT | 4-SEASON KIT

Configure Yours at

WWW.JAMAICACOTTAGESHOP.COM

10X16 SUGAR SHACK

STORAGE
SOLUTIONS



10X16 SUGAR SHACK COMPLETE PRE-CUT KIT

Base Area: 160 sq. ft.

Total Interior Area: 160 sq. ft.

Recommended Foundation:
6-8" Crushed Gravel

Overall Dimensions: 12'3"H
x 11'2"W x 17'2"D

Estimated Weight: 5400 lbs

Sill Plates

6x6 Treated Sill Plate

Walls

4"x4" Hemlock Post and
Beam Wall Framing

Wall Height: 78"

Siding: 1" rough sawn
Pine Board & Batten

1" rough sawn Pine Corner, Door
& Window Trim & 2" rough sawn
Pine Fascia & Shadow Trim

Roof

Gable Roof Style

Roof Pitch: 6/12

Roof Features: 4x8 Pine Venting
Cupola over 94 1/2"x44 1/2"
Rough Opening in Roof

The complete pre-cut kit includes hemlock framing, pine board and batten siding, floor decking, corrugated metal roof, cupola, double doors and barn sash windows. Note: Pictures may reflect client upgrades and modifications that do not come standard.

2"x6" rough sawn Hemlock
Rafters 24" On Center

1"x6" rough sawn Hemlock
Exposed Collar Ties

1"x4" rough sawn Hemlock
Strapping 20" On Center

Corrugated 29g Metal
Roofing, Color: Evergreen

Doors & Windows:

Doors: 1 (qty) 5-0 JCS-built 2" Thick
rough sawn Pine Double Doors
w/ 3x5 Pressure Treated Ramp

Windows: 2 (qty) 3'x2' eight-lite
Hinged Barn Sash Window

Additional Features

1 (qty) Wood Louvered Vent

Assembly & Logistics Information

Estimated Assembly Time:
Two People: 32 hrs

Estimated Shipping Cube Sizes
Cube 1: 42"x44"x192"

SUGSHK.10X16.PCK