

COMPLETE Pre-Cut Kit

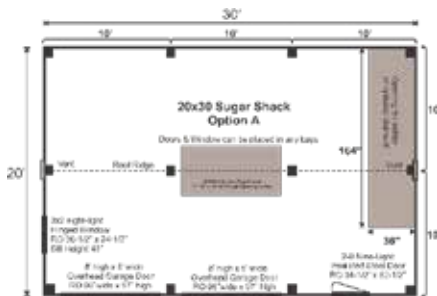

A traditional New England design, the Sugar Shack boasts functionality and aesthetic appeal. Sugar Shacks are traditionally used as a designated building to boil maple syrup. In the springtime a large cloud of smoke and steam can be seen rising high above a sugar shack.



COMPLETE PRE-CUT KIT:

A weather tight shell. The PCK is the complete kit for a design. It includes everything required to assemble the building shell and includes doors and windows.

EVERY KIT INCLUDES

- Color Coded
- Part Numbered
- Step-by-Step Instructions
- & All Fastening Hardware Included

Additional Sizes:

8X10 | 8X12 | 8X14 | 8X16 | 10X16 | 10X20 | 12X16 | 12X20 | 12X24 | 14X20 | 14X24 | 16X20 | 16X24 | 16X30 | 12X30 | 20X40 |

Additional Types:

FRAME ONLY KIT | COMPLETE KIT | FULLY ASSEMBLED | 3-SEASON KIT | 4-SEASON KIT

Configure Yours at

WWW.JAMAICACOTTAGESHOP.COM

20X30 SUGAR SHACK

STORAGE SOLUTIONS



20X30 SUGAR SHACK COMPLETE PRE-CUT KIT

Base Area: 600 sq. ft.

Loft Area: 600 sq. ft.

Total Interior Area: 1200 sq. ft.

Recommended Foundation:
20'x30' Concrete Slab, Full
Foundation, Crawl Space

Overall Dimensions: 20'H
x 32'4"W x 22'4"D

Estimated Weight: 18400 lbs

Sill Plates

2x10 Treated Sill Plate

Loft

20x30

Ladder Access (Staircase Optional)

4x6 rough sawn Hemlock

Joists 24" on center

1" rough sawn Pine Board Decking

Weight Rating 25 lbs / sqft

Walls

8x8 Hemlock Post &

Beam Wall Framing

Wall Height: 144"

Siding: Kiln Dried Pine Shiplap

1" Pine Fascia and Shadow Boards &

1" Pine Trim Detail & 1" Soffit Backing

Roof

Gable Roof Style

Roof Pitch: 8/12

The complete pre-cut kit includes hemlock framing, pine board and batten siding, floor decking, corrugated metal roof, cupola, double doors and barn sash windows. Note: Pictures may reflect client upgrades and modifications that do not come standard.

Roof Features: 4x8 Pine Venting
Cupola over 94 1/2"x44 1/2"

Rough Opening in Roof

2"x10" rough sawn Hemlock

Rafters 16" On Center

2"x6" rough sawn Hemlock

Exposed Collar Ties

1" rough sawn Solid Barn

Board Roof Sheathing

Roof Vapor Barrier

Corrugated 29g Metal Roofing,

Color: Evergreen

Doors & Windows:

Doors: 1 2-8 nine-lite Insulated Steel

Door with Keyless Lever Locking

Hardware, 2 (qty) 8'w x 8'h Overhead

Garage Door, No Windows, No

Insulation, No Ramp; Color: Sandstone

Windows: 1 (qty) 3'x2' eight-lite

Hinged Barn Sash Window

Assembly & Logistics Information

Estimated Assembly Time:

Two People: 80 hrs

Estimated Shipping Cube Sizes

Cube 1: 42"x57"x48" Cube 2:

42"x45"x120" Cube 3: 42"x60"x120"

Cube 4: (qty 2) 42"x35"x168"

Cube 5: (qty 2) 42"x35"x192"

Cube 6: (qty 2) 42"x35"x156"

SUGSHK.20X30.PCK