

# FULLY ASSEMBLED

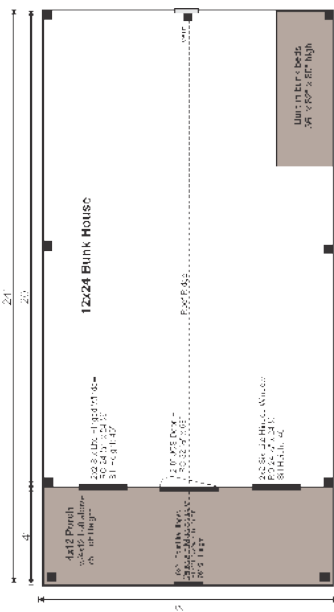

Our Bunkhouse is the perfect cabin for a family outing, hunting cabin, or to pack in a bunch of munchkins for a backyard sleepover. The smallest of this design sleeps three with a set of bunk beds and a loft above the 4' porch.



## FULLY ASSEMBLED:

A weather tight shell. Specifications are the same as a PCK. Fully assembled prefabricated sheds and cottage buildings deliver exclusively to the northeast USA.

### EVERY KIT INCLUDES

- Color Coded
- Part Numbered
- Step-by-Step Instructions
- All Fastening Hardware Included

Configure Yours at

[WWW.JAMAICACOTTAGESHOP.COM](http://WWW.JAMAICACOTTAGESHOP.COM)

## 12X24 BUNKHOUSE

STORAGE SOLUTIONS



## 12X24 BUNKHOUSE FULLY ASSEMBLED

Base Area: 288 sq. ft.

Loft Area: 48 sq. ft.

Total Interior Area: 288 sq. ft.

Porch Area: 48 sq. ft.

Recommended Foundation:  
8-10" Crushed Gravel

Overall Dimensions: 10'6"H x 13'2"W x 25'2"D

Estimated Weight: 7100 lbs

### Floor System

2 (qty) 6x6x24' Hemlock Skids

2"x6" rough sawn Hemlock

Joists 24" On Center

3/4" CDX Plywood Floor Decking

1" rough sawn Hemlock Porch Decking

Floor Weight Rating: 25 lbs/sq. ft.

### Loft

4x12

Ladder Access

2"x6" rough sawn Hemlock Joists 24" on center

Smooth Shiplap Pine Loft Decking

Weight Rating 10 lbs / sqft

### Walls

4"x4" Hemlock Post and Beam Wall Framing

Wall Height: 82"

Siding: 1" rough sawn Pine Board & Batten

The fully assembled unit includes hemlock framing, pine board and batten siding, floor decking, corrugated metal roof, windows and doors. Note: Pictures may reflect client upgrades and modifications that do not come standard.

1" rough sawn Pine Corner, Door & Window Trim & 2" rough sawn Pine Fascia & Shadow Trim

### Roof

Asymmetrical Gable Roof Style

Roof Pitch: 4/12 Porch: 4/12

2"x6" rough sawn Hemlock

Rafters 24" On Center

2"x6" rough sawn Hemlock Exposed Collar Ties

1"x4" rough sawn Hemlock

Strapping 20" On Center

Corrugated 29g Metal Roofing,  
Color: Evergreen

### Door & Windows:

Door: 1 (qty) 2-8 JCS-built 2" Thick rough sawn Pine Single Door, no ramp

Windows: 2 (qty) 2'x2' six-lite Hinged Barn Sash Window, 1 (qty) 16"x21" four-lite Hinged Barn Sash Window

### Additional Features

1 (qty) Wood Louvered Vent

Built-In Bunk Beds rough sawn Pine 36"x82"x80" High

### Delivery & Logistics Information

Fully Assembled prefabricated sheds and cottage buildings are deliverable exclusively to the Northeast USA.

BKNH.12X24.FA

STORAGE SOLUTIONS