

COMPLETE Pre-Cut Kit

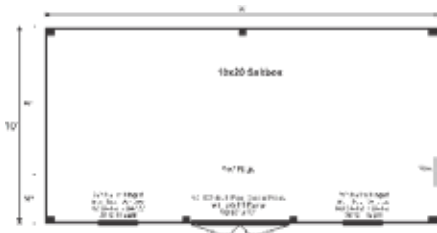

A New England staple, with colonial charm—the Saltbox begs the word “tradition.” Featuring a distinct asymmetrical roof style, it is not only elegant, but practical. This design allows rain and snow to shed off easily, mostly to the rear.



COMPLETE PRE-CUT KIT:

A weather tight shell. The PCK is the complete kit for a design. It includes everything required to assemble the building shell and includes doors and windows.

EVERY KIT INCLUDES

- Color Coded
- Part Numbered
- Step-by-Step Instructions
- & All Fastening Hardware Included

Additional Sizes:

4X6 | 4X8 | 8X8 | 8X10 | 8X12 | 8X14 | 8X16 |
10X8 | 10X10 | 10X12 | 10X14 | 10X16 | 10X18 |
10X20 | 12X12 | 12X14 | 12X16 | 12X20 | 12X24

Additional Types:

FRAME ONLY KIT | COMPLETE KIT | FULLY
ASSEMBLED | 3-SEASON KIT | 4-SEASON KIT

Configure Yours at

WWW.JAMAICACOTTAGESHOP.COM

10X20 SALTBOX

STORAGE
SOLUTIONS



10X20 SALTBOX COMPLETE PRE-CUT KIT

Base Area: 200 sq. ft.

Total Interior Area: 200 sq. ft.

Recommended Foundation:

6–8" Crushed Gravel

Overall Dimensions: 10'6"H
x 21'2"W x 11'10"D

Estimated Weight: 5300 lbs

Floor System

2 (qty) 6x6x20' Hemlock Skids

2"x6" rough sawn Hemlock

Joists 24" On Center

¾" CDX Plywood Floor Decking

Floor Weight Rating: 25 lbs/sq. ft.

Walls

4"x4" Hemlock Post and

Beam Wall Framing

Wall Height: Front: 83" Rear: 63"

Siding: 1" rough sawn

Pine Board & Batten

1" rough sawn Pine Corner, Door

& Window Trim & 2" rough sawn

Pine Fascia & Shadow Trim

Roof

Saltbox Roof Style

Roof Pitch: Front: 12/12 Rear: 6/12

The complete pre-cut kit includes hemlock framing, pine board and batten siding, floor decking, corrugated metal roof, double doors and barn sash windows. Note: Pictures may reflect client upgrades and modifications that do not come standard.

2"x6" rough sawn Hemlock
Rafters 24" On Center

1"x6" rough sawn Hemlock
Exposed Collar Ties

1"x4" rough sawn Hemlock
Strapping 20" On Center

Corrugated 29g Metal
Roofing, Color: Evergreen

Doors & Windows:

Door: 1 (qty) 5-0 JCS-built 2" Thick
rough sawn Pine Double Doors
w/ 3x5 Pressure Treated Ramp

Windows: 2 (qty) 2'x2' six-lite
Hinged Barn Sash Window

Additional Features

1 (qty) Wood Louvered Vent

Assembly & Logistics Information

Estimated Assembly Time:

Two People: 32 hrs

Estimated Shipping Cube Sizes

Cube 1: 42"x32"x168"

Cube 2: 42"x40"x144"

SLBX.10X20.PCK