

COMPLETE Pre-Cut Kit

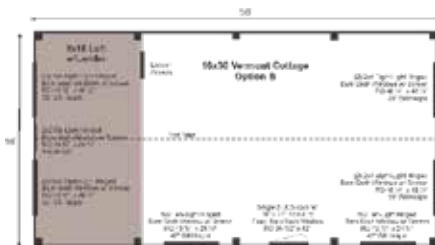

Rugged post and beam techniques passed down for centuries are the foundation of this sturdy, picturesque retreat reminiscent of old New England. Handmade from native Rough Sawn Vermont Hemlock and Pine, this kit comes with everything you need to have your own Cabin in the woods.



COMPLETE PRE-CUT KIT:

A weather tight shell. The PCK is the complete kit for a design. It includes everything required to assemble the building shell and includes doors and windows.

EVERY KIT INCLUDES

- Color Coded
- Part Numbered
- Step-by-Step Instructions
- All Fastening Hardware Included

Additional Sizes:

16X20 | 16X24 | 16X30 |

Additional Types:

FRAME ONLY KIT | COMPLETE KIT |
3-SEASON KIT | 4-SEASON KIT

Configure Yours at

WWW.JAMAICACOTTAGESHOP.COM

16X30 VERMONT COTTAGE B STORAGE SOLUTIONS



16X30 VERMONT COTTAGE B COMPLETE PRE-CUT KIT

Base Area: 480 sq. ft.

Loft Area: 128 sq. ft.

Total Interior Area: 608 sq. ft.

Recommended Foundation:

Compacted 12" Crushed Gravel

Overall Dimensions: 14'6"H x 18'W x 32'D

Estimated Weight: 13900 lbs

Floor System

3 (qty) 6x6x30' Hemlock Skids

2"x6" rough sawn Hemlock

Joists 16" On Center

¾" CDX Plywood Floor Decking

Floor Weight Rating: 25 lbs/ sq. ft.

Loft

8x16

Ladder Access

2"x6" rough sawn Hemlock

Joists 24" on center

Smooth Shiplap Pine Loft Decking

Weight Rating 10 lbs / sqft

Walls

4"x4" Hemlock Post and

Beam Wall Framing

Wall Height: 96"

Siding: 1" rough sawn Pine Board & Batten

1" rough sawn Pine Corner, Door,

Window, Fascia & Shadow Trim

The complete pre-cut kit includes hemlock framing, pine board and batten siding, floor decking, corrugated metal roof, pine door and barn sash windows. Note: Pictures may reflect client upgrades and modifications that do not come standard.

Roof

Gable Roof Style

Roof Pitch: 8/12

2"x6" rough sawn Hemlock

Rafters 24" On Center

2"x6" rough sawn Hemlock

Exposed Collar Ties

1"x4" rough sawn Hemlock

Strapping 20" On Center

Corrugated 29g Metal Roofing,

Color: Evergreen

12" Overhangs on all sides

Door & Windows:

Door: 1 (qty) 3-0 JCS-built 2" Thick rough sawn Pine Single Door with 16"x21" Fixed Window and black thumb latch, no ramp

Windows: 2 (qty) 4'x2' ten-lite Hinged

Barn Sash Window with Screens, 1 (qty)

2'x2' six-lite Hinged Barn Sash Window

with Screen, 8 (qty) 2'x4' eight-lite Hinged

Barn Sash Windows with Screens

Assembly & Logistics Information

Estimated Assembly Time:

Two People: 50 hrs

Estimated Shipping Cube Sizes

Cube 1: 42"x50"x192" Cube 2:

42"x50"x192" Cube 3: 42"x38"x168"

VTCB.16X30.PCK