



Jamaica Cottage Shop
EST. 1995

Firewood Storage and Yard Organization

THE WEEKENDER



MODEL WKND

*Double Duty
Firewood Storage*

Sizes:

4x8	6x14	8x20
4x10	6x16	10x16
4x12	8x14	10x20
6x12	8x16	12x20



SPECIFICATIONS



4x8



4x10



4x12



6x12

Footprint	32 sqft	40 sqft	48 sqft	72 sqft
Storage Capacity	0.5 Cords	1 Cord	1 Cord	1.5 Cords
Dimensions	9'9"W x 6'5"L x 8'6"H	10'9"W x 6'5"L x 8'6"H	12'6"W x 6'5"L x 8'6"H	13'2"W x 7'6"L x 10'6"H
Foundation	6-8" Crushed Gravel	8-10" Crushed Gravel	8-10" Crushed Gravel	10-12" Crushed Gravel
Floor Base	(2) 4x6x8' Skids (Option for No Floor—Sub Treated Sills)	(2) 4x6x10' Skids (Option for No Floor—Sub Treated Sills)	(2) 4x6x12' Skids (Option for No Floor—Sub Treated Sills)	(2) 4x6x12' Skids (Option for No Floor—Sub Treated Sills)
Floor Joists	2x6" rough sawn Hemlock Joists 24" On Center			
Weight Rating	170 lbs/sqft (Option to upgrade)			190 lbs/sqft (Upgrade Options)
Floor Decking	¾" CDX Plywood (Enclosed Side), 1" rough sawn Hemlock (Open Side) Floor Decking (Option to upgrade)			
Wall Framing	4x4" Hemlock Post and Beam Wall Framing			
Wall Height	80" Front, 50" Rear			82" Front, 58" Rear
Siding	1" rough sawn Pine Board, Battens added on Enclosed Side (Options Available)			
Trim	1" rough sawn Pine Corner & Door Trim & 1" rough sawn Pine Fascia & Shadow Trim			1" rough sawn Pine Corner & Door Trim & 2" rough sawn Pine Fascia & Shadow Trim
Roof Style and Pitch	Saltbox Roof 8/12 front, 8/12 rear			Saltbox Roof 12/12 front, 6/12 rear
Rafters	2x6" rough sawn Hemlock Rafters 24" OC (Options Available)			
Roof Features	1x6" rough sawn Hemlock Exposed Collar Ties			

HOW MANY CORDS?

When choosing your Weekender, consider how many cords of wood you typically use. If you live in a colder climate and rely on firewood for your heating, expect to use four to five cords of wood to get you through the winter.

Whether you only light the occasional fire for ambiance, or you rely on a wood burning stove for your heating, we have a Weekender that will fit all your tinder.

You should keep your firewood neatly stacked to encourage airflow and help it dry.



FLOOR PLANS

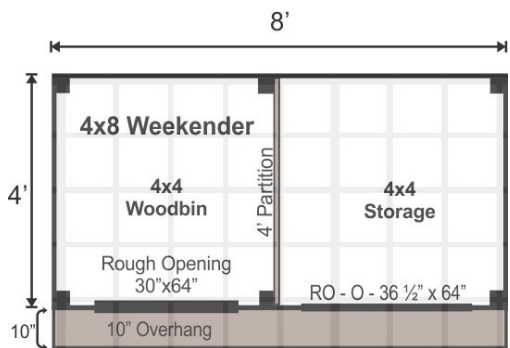

4x8
0.5 Cords

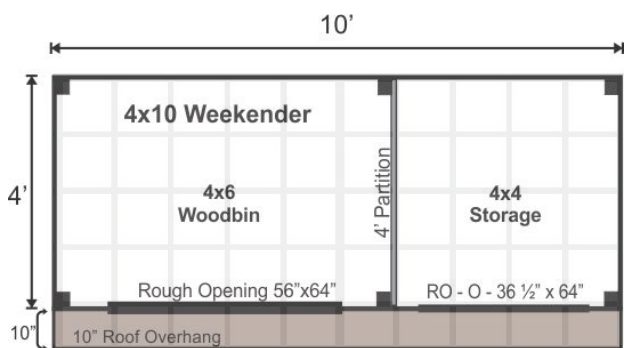

4x10
1 Cord

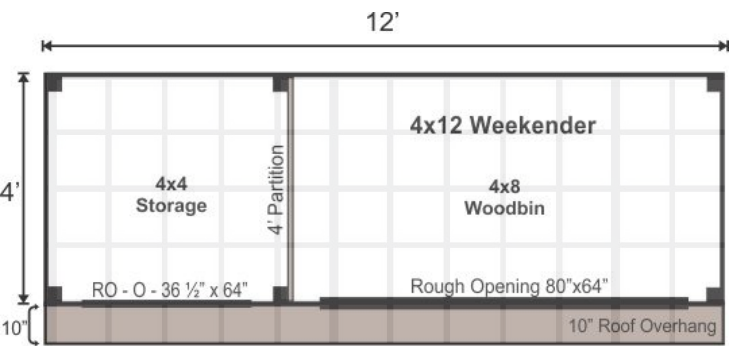

4x12
1 Cord

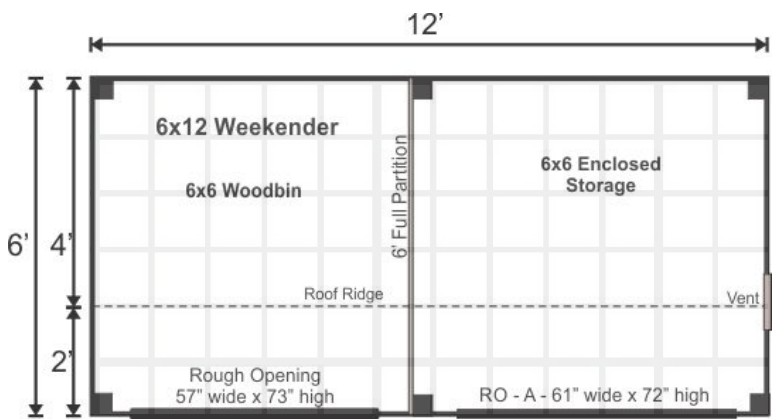

6x12
1.5 Cords

SPECIFICATIONS

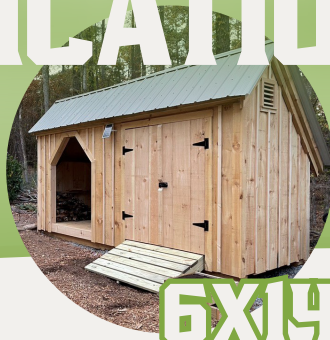

6X14



6X16



8X14



8X16

Footprint	84 sqft	96 sqft	112 sqft	128 sqft
Storage Capacity	2 Cords	2 Cords	2.5 Cords	3 Cords
Dimensions	15'2"W x 7'6"L x 10'6"H	17'2"W x 7'6"L x 10'6"H	15'2"W x 9'6"L x 10'6"H	17'2"W x 9'6"L x 10'6"H
Foundation	12" Crushed Gravel	12" Crushed Gravel	12" Crushed Gravel	12" Crushed Gravel
Floor Base	(2) 4x6x14' Skids (Option for No Floor—Sub Treated Sills)	(2) 6x6x16' Skids (Option for No Floor—Sub Treated Sills)	(2) 4x6x14' Skids (Option for No Floor—Sub Treated Sills)	(2) 6x6x16' Skids (Option for No Floor—Sub Treated Sills)
Floor Joists	2x6" rough sawn Hemlock Joists 24" On Center			2x6" rough sawn Hemlock Joists 16" On Center
Weight Rating	190 lbs/sqft (Upgrade Options)	190 lbs/sqft (Upgrade Options)	210 lbs/sqft (Upgrade Options)	210 lbs/sqft (Upgrade Options)
Floor Decking	¾" CDX Plywood (Enclosed Side), 1" rough sawn Hemlock (Open Side) Floor Decking (Option to upgrade)			
Wall Framing	4x4" Hemlock Post and Beam Wall Framing			
Wall Height	82" Front, 58" Rear	82" Front, 58" Rear	83" Front, 71" Rear	83" Front, 71" Rear
Siding	1" rough sawn Pine Board, Battens added on Enclosed Side (Options Available)			
Trim	1" rough sawn Pine Corner & Door Trim & 2" rough sawn Pine Fascia & Shadow Trim			
Roof Style and Pitch	Saltbox Roof 12/12 front, 6/12 rear			
Rafters	2x6" rough sawn Hemlock Rafters 24" OC (Options Available)			
Roof Features	1x6" rough sawn Hemlock Exposed Collar Ties			

Customizing Your Weekender

SIDING: Board and Batten comes standard, with many more options available.

ROOF: Customize your color of Galvalume metal, or upgrade your roofing material to Asphalt or Cedar Shingles

STRENGTH: Enhance the strength of your building by upgrading the rafters from 24 inch On Center to 16 inch On Center

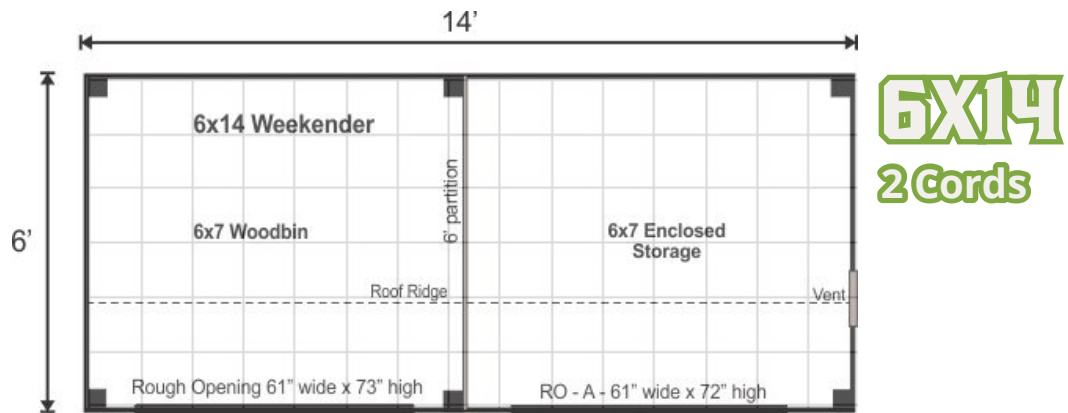

6X14
2 Cords

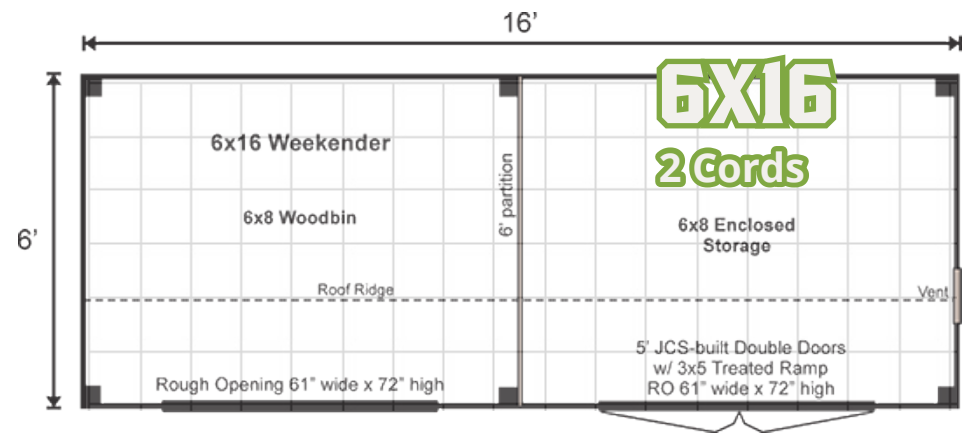

6X16
2 Cords

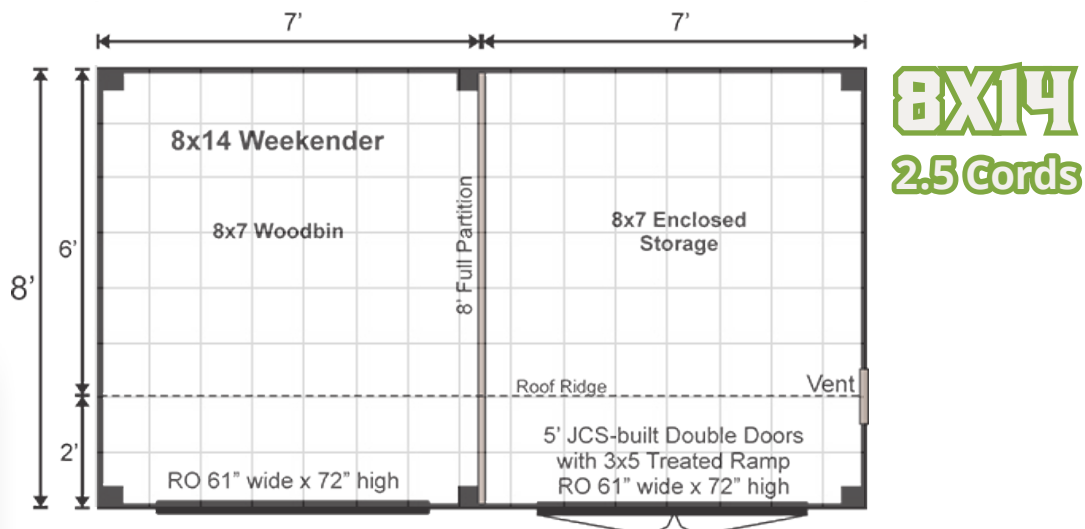

8X14
2.5 Cords

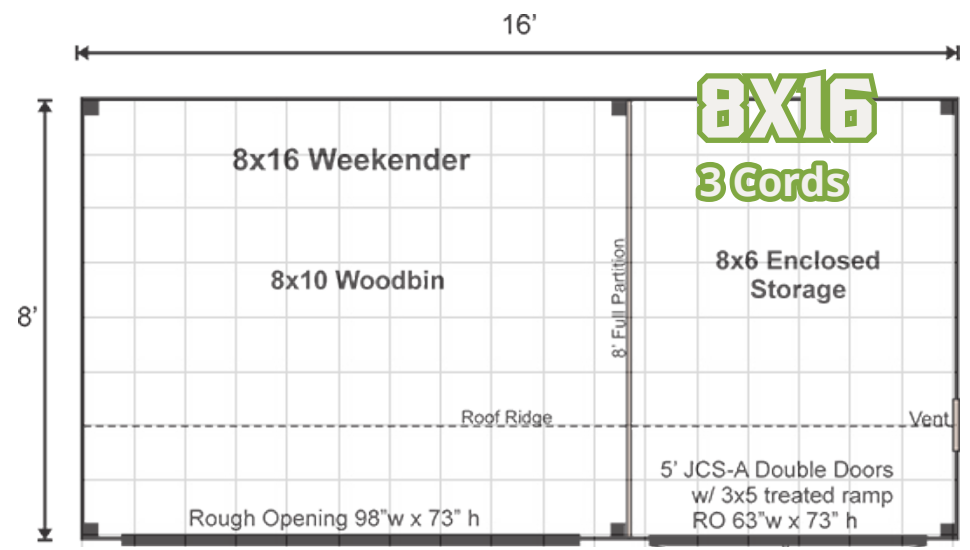

8X16
3 Cords

SPECIFICATIONS



8X20



10X16



10X20



12X20

Footprint	160 sqft	160 sqft	200 sqft	240 sqft
Storage Capacity	4 Cords	4 Cords	5 Cords	6 Cords
Dimensions	21'2"W x 9'6"L x 10'6"H	17'2"W x 11'6"L x 10'6"H	21'2"W x 11'6"L x 10'6"H	21'2"W x 13'6"L x 10'6"H
Foundation	12" Crushed Gravel	12" Crushed Gravel	12" Crushed Gravel	12" Crushed Gravel
Floor Base	(2) 6x6x20' Skids (Option for No Floor—Sub Treated Sills)	(2) 6x6x16' Skids (Option for No Floor—Sub Treated Sills)	(2) 6x6x20' Skids (Option for No Floor—Sub Treated Sills)	(2) 6x6x20' Skids (Option for No Floor—Sub Treated Sills)
Floor Joists	2x6" rough sawn Hemlock Joists, 16" On Center	2x6" rough sawn Hemlock Joists 24" On Center	2x6" rough sawn Hemlock Joists, 16" On Center	2x6" rough sawn Hemlock Joists, 16" On Center
Weight Rating	210 lbs/sqft (Upgrade Options)	200 lbs/sqft (Upgrade Options)	200 lbs/sqft (Upgrade Options)	200 lbs/sqft (Upgrade Options)
Floor Decking	3/4" CDX Plywood (Enclosed Side), 1" rough sawn Hemlock (Open Side) Floor Decking (Option to upgrade)			
Wall Framing	4x4" Hemlock Post and Beam Wall Framing			
Wall Height	83" Front, 71" Rear	83" Front, 63" Rear	83" Front, 63" Rear	83" Front, 67" Rear
Siding	1" rough sawn Pine Board, Battens added on Enclosed Side (Options Available)			
Trim	1" rough sawn Pine Corner & Door Trim & 2" rough sawn Pine Fascia & Shadow Trim			
Roof Style and Pitch	Saltbox Roof 12/12 front, 6/12 rear	Saltbox Roof 10/12 Front, 6/12 Rear	Saltbox Roof 12/12 front, 6/12 rear	Saltbox Roof 12/12 Front, 4/12 Rear
Rafters	2x6" rough sawn Hemlock Rafters 24" OC (Options Available)			
Roof Features	1x6" rough sawn Hemlock Exposed Collar Ties			

FEATURES



Ramp it up!

The Weekender comes with a ramp that is sized to the building's door to help you load up your lawnmower or any other equipment you need to wheel inside. Add a second ramp for even more convenience!

Customers added a second ramp

Saltbox Style Roof

The classic saltbox style roof sheds most water and snow to the rear of the building. The eaves on the front help keep moisture from entering the wood storage compartment. You'll love the classic design and practicality of this roofing style.

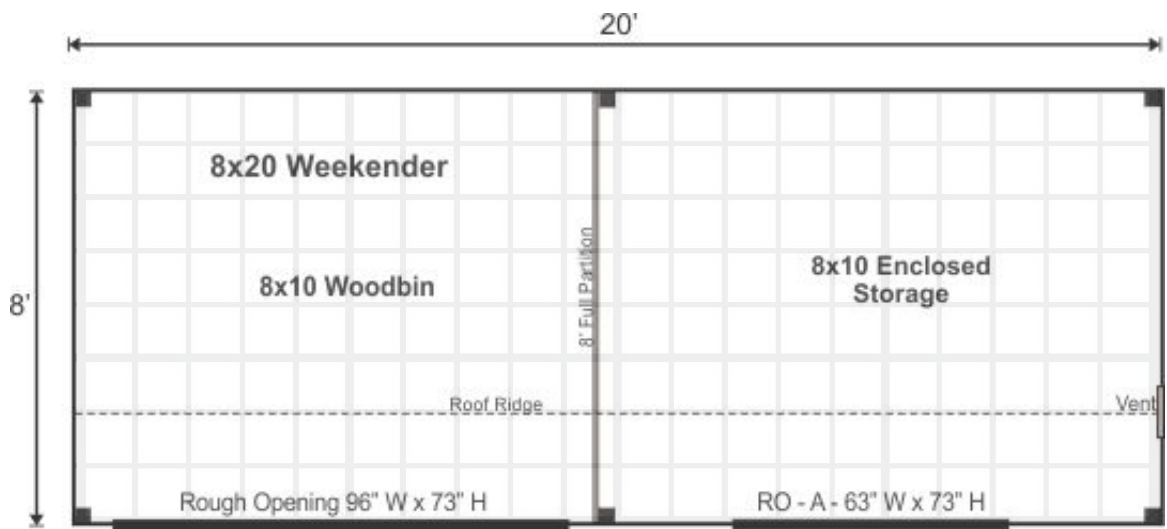

8X20
4 Cords

10X16
4 Cords

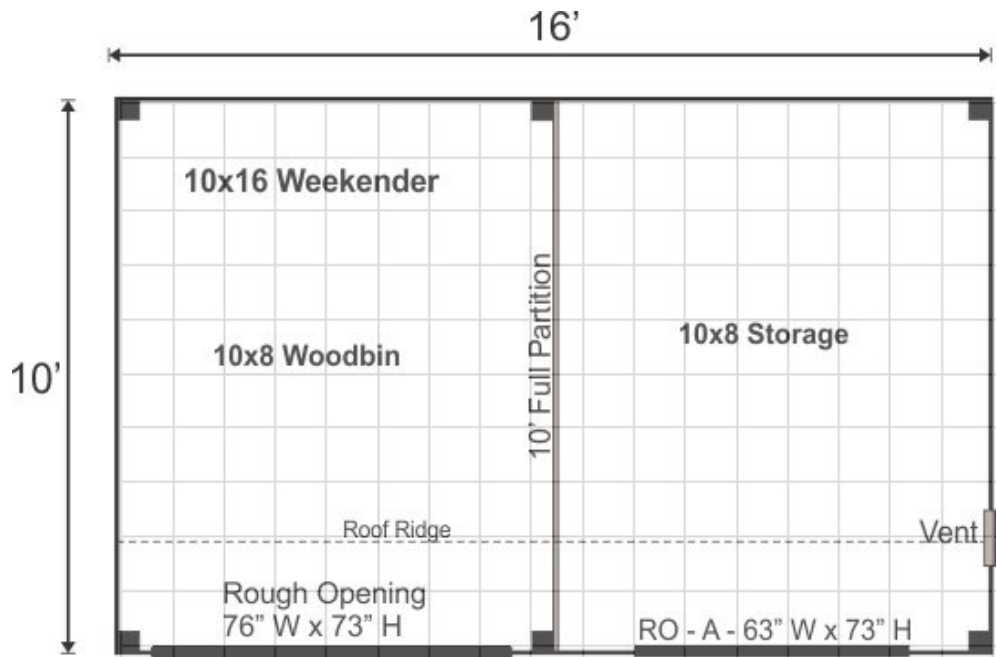

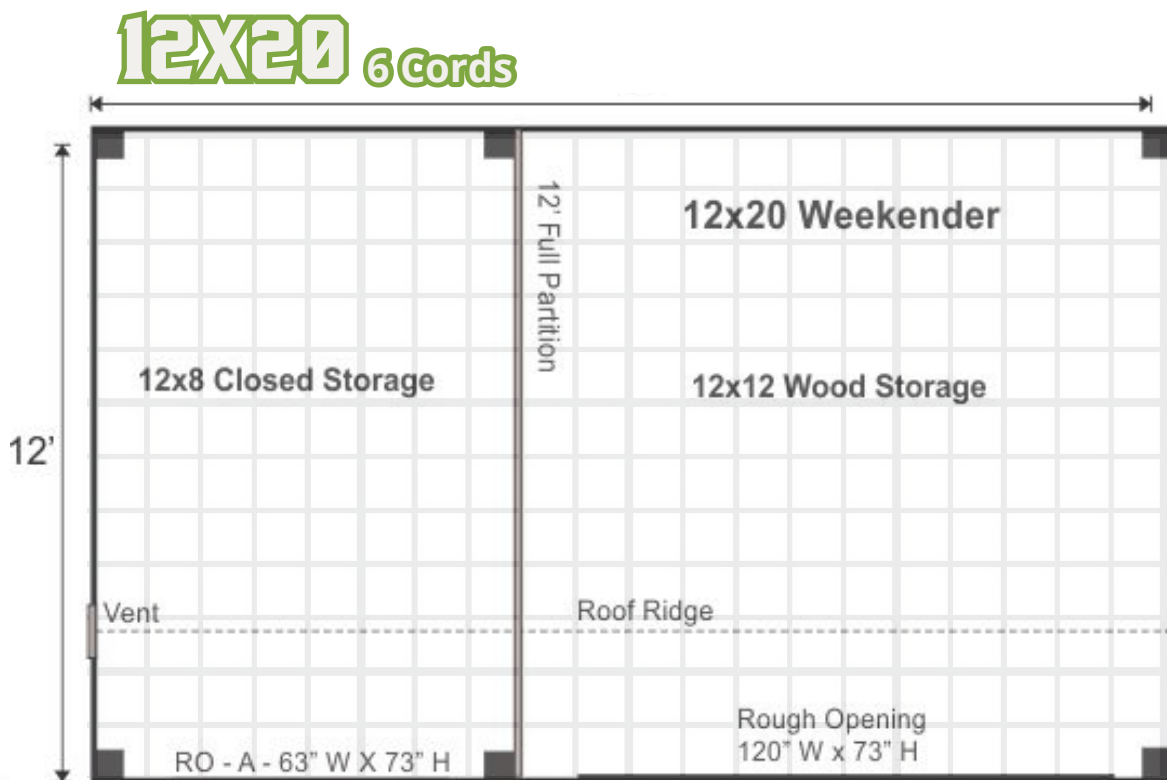
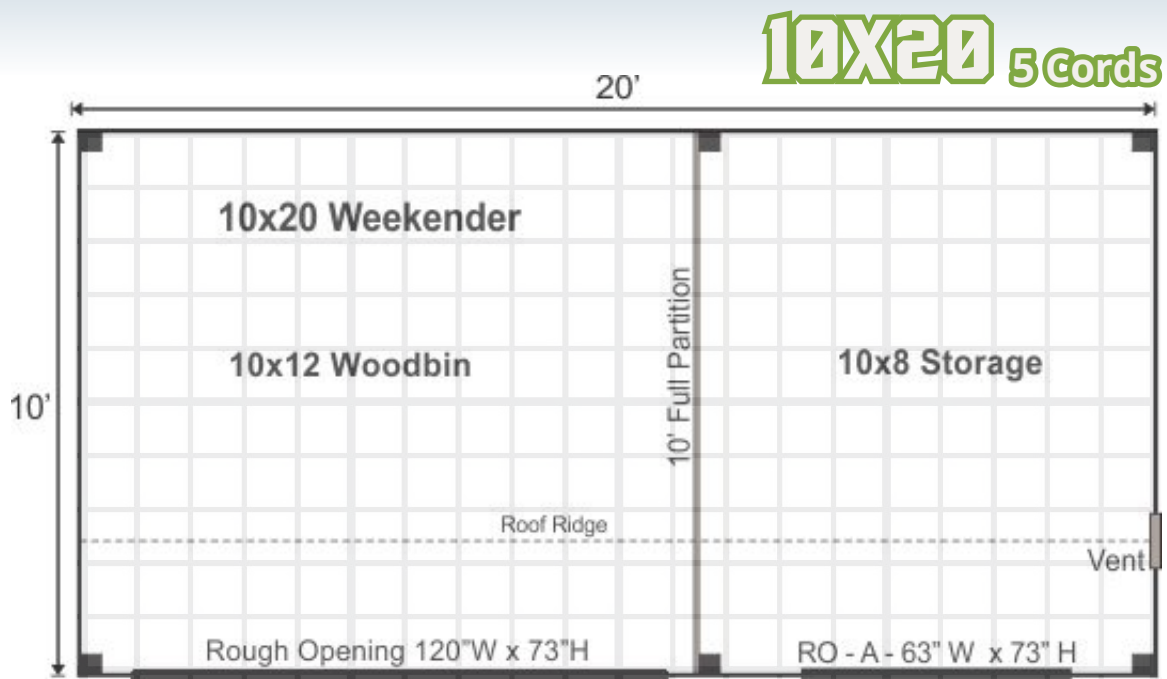

Looking for a Custom Weekender?

Contact Our Design Team

802-444-8199 — design@jamaicacottageshop.com

MODEL WKND